



Vanguard P/N	M21038/27	Turns Ratio (±3%)	Turns Ratio		Rise Time T _{RISE} (nS)	DCR max (Ohms)	Impedance min (Ohms)	Configuration
			PRI	SEC				
49206	-01	1 : 1	1-3	4-8	150	1-3 3.0	(1-3)	A
		1 : .707	1-3	5-7		4-8 3.0	4000	
49207	-02	1.4 : 1	1-3	4-8	150	1-3 3.5	(1-3)	A
		2 : 1	1-3	5-7		4-8 3.0	7200	
100658	-03	1.25 : 1	1-3	4-8	150	1-3 3.2	(1-3)	A
		1.66 : 1	1-3	5-7		4-8 3.0	4000	
100659	-04	2.3 : 1	4-8	1-3	150	1-3 1.2	(5-7)	A
		3.2 : 1	5-7	1-3		4-8 3.0	3000	
100660	-05	1 : 1.41	1-2	4-3	150	1-2 2.2 4-3 2.7	(4-3) 3000	C
49208	-06	1 : 1	1-5	6-2	150	1-5 2.5 6-2 2.8	(1-5) 3000	B
49209	-07	1 : 1.41	1-5	6-2	150	1-5 2.2 6-2 2.7	(6-2) 3000	B
49210	-08	1 : 1.66	1-5	6-2	150	1-5 1.5 6-2 2.4	(6-2) 3000	B
49211	-09	1 : 2	1-5	6-2	200	1-5 1.3 2-6 2.6	(6-2) 3000	B
49212	-10	1 : 2.12	1-3	4-8	200	1-3 1.0	(4-8)	A
		1 : 1.5	1-3	5-7		4-8 3.5	4000	
100661	-11	1 : 1	1-3	4-8	150	1-3 3.0	(1-3)	D
		1 : .707	1-3	5-7		4-8 3.0	4000	
49213	-12	1.4 : 1	1-3	4-8	150	1-3 3.5	(1-3)	D
		2 : 1	1-3	5-7		4-8 3.0	7200	
49214	-13	1.25 : 1	1-3	4-8	150	1-3 3.2	(1-3)	D
		1.66 : 1	1-3	5-7		4-8 3.0	4000	
100662	-14	2.3 : 1	4-8	1-3	150	1-3 1.2	(5-7)	D
		3.2 : 1	5-7	1-3		4-8 3.0	3000	
100663	-15	1 : 2.12	1-3	4-8	200	1-3 1.0	(4-8)	D
		1 : 1.5	1-3	5-7		4-8 3.5	4000	
49215	-16	1 : 1	1-3	4-8	150	1-3 3.0	(1-3)	E
		1 : .707	1-3	5-7		4-8 3.0	4000	
100664	-17	1.4 : 1	1-3	4-8	150	1-3 3.5	(1-3)	E
		2:1	1-3	5-7		4-8 3.0	7200	
100665	-18	1.25 : 1	1-3	4-8	150	1-3 3.2	(1-3)	E
		1.66 : 1	1-3	5-7		4-8 3.0	4000	
100666	-19	2.3 : 1	4-8	1-3	150	1-3 1.2	(5-7)	E
		3.2 : 1	5-7	1-3		4-8 3.0	3000	
100667	-20	1 : 2.12	1-3	4-8	200	1-3 1.0	(4-8)	E
		1 : 1.5	1-3	5-7		4-8 3.5	3000	

CUSTOM DESIGNS & MODIFICATIONS:

Other electrical configurations and performance characteristics are available in various sizes and package types





Vanguard P/N	M21038/27	Turns Ratio (±3%)	PRI	SEC	Rise Time T _{RISE} (nS)	DCR max (Ohms)	Impedence min (Ohms)	Configuration
100668	-21	1 : 1 1 : .707	1-3 1-3	4-8 5-7	150	1-3 3.0 4-8 3.0	(1-3) 4000	F
100669	-22	1.4 : 1 2 : 1	1-3 1-3	4-8 5-7	150	1-3 3.5 4-8 3.0	(1-3) 7200	F
100670	-23	1.25 : 1 1.66 : 1	1-3 1-3	4-8 5-7	150	1-3 3.2 4-8 3.0	(1-3) 4000	F
100671	-24	1 : 2.12 1 : 1.5	1-3 1-3	4-8 5-7	200	1-3 1.0 4-8 3.5	(4-8) 4000	F
100672	-25	1 : 2.5 1 : 1.79	1-3 1-3	4-8 5-7	250	1-3 1.0 4-8 3.5	(4-8) 4000	F
49216	-26	1 : 2.5 1 : 1.79	1-3 1-3	4-8 5-7	250	1-3 1.0 4-8 3.5	(4-8) 4000	A
49217	-27	1 : 1.79 1 : 2.5	1-3 1-3	5-7 4-8	250	1-3 1.0 4-8 3.5	(4-8) 4000	D
100673	-28	1 : 1.5	1-5	6-2	150	1-5 .90 6-2 2.5	(6-2) 3000	B
100674	-29	1 : 1.79	1-5	6-2	150	1-5 .90 6-2 2.5	(6-2) 3000	B
100675	-30	1 : 2.5	1-5	6-2	250	1-5 1.0 6-2 2.8	(6-2) 3000	B
100676	-31	1 : 2.5 1 : 1.79	1-3 1-3	4-8 5-7	250	1-3 1.0 4-8 3.5	(4-8) 4000	E

CUSTOM DESIGNS & MODIFICATIONS:

Other electrical configurations and performance characteristics are available in various sizes and package types

M21038/27 SERIES





CONFIGURATION - A

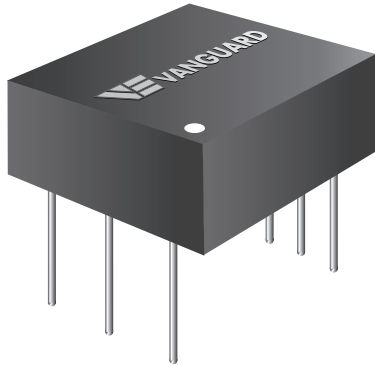

TOP VIEW

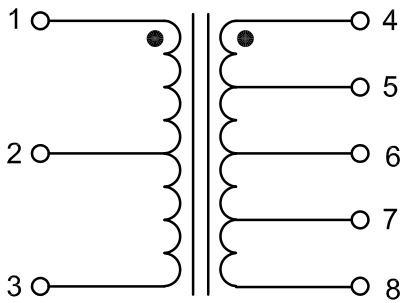
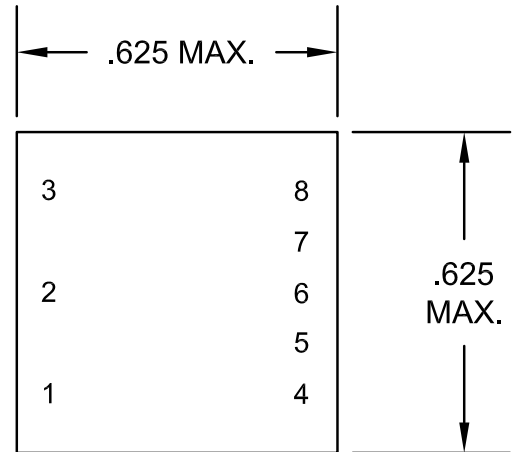

SCHEMATIC FOR -01, -02, -03, -10, & -26

SIDE VIEW

DASH NUMBER	"A" MAX.
-01, -04	.300
-02, -03, -10, -26	.250

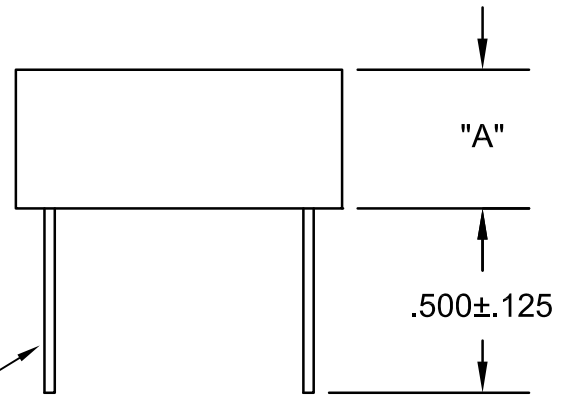

Ø .020±.002, 8 PL SOLDER PLATED

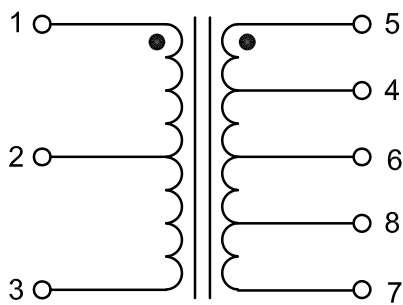

SCHEMATIC FOR -04

BOTTOM VIEW

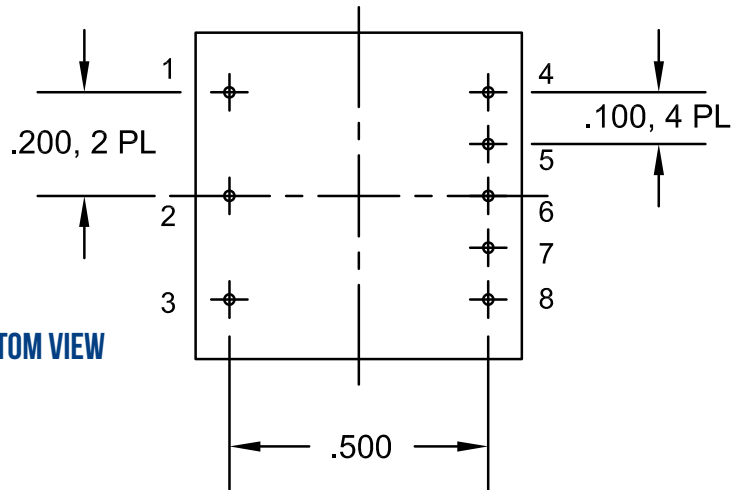

CUSTOM DESIGNS & MODIFICATIONS:

Other electrical configurations and performance characteristics are available in various sizes and package types

M21038/27 SERIES





CONFIGURATION - B

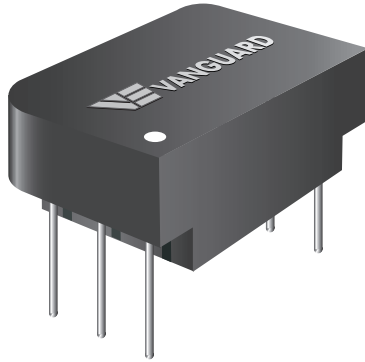

TOP VIEW

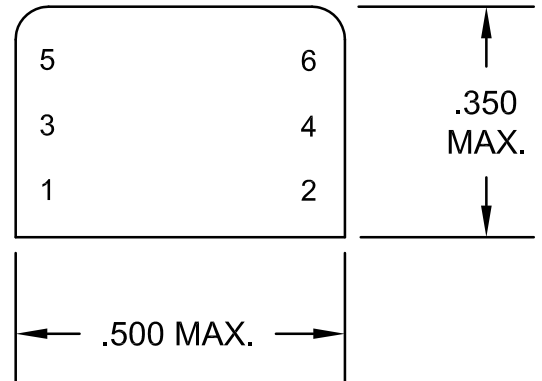

SIDE VIEW

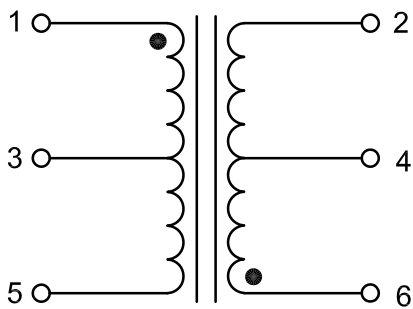
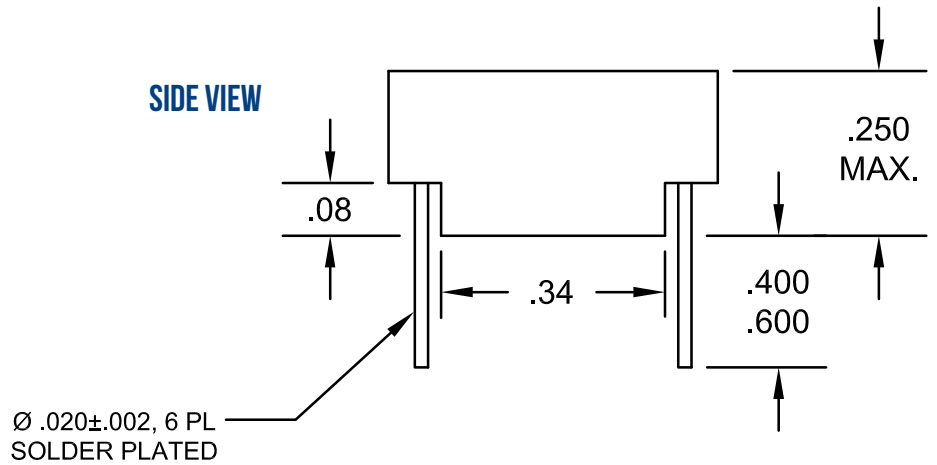

SCHEMATIC

BOTTOM VIEW

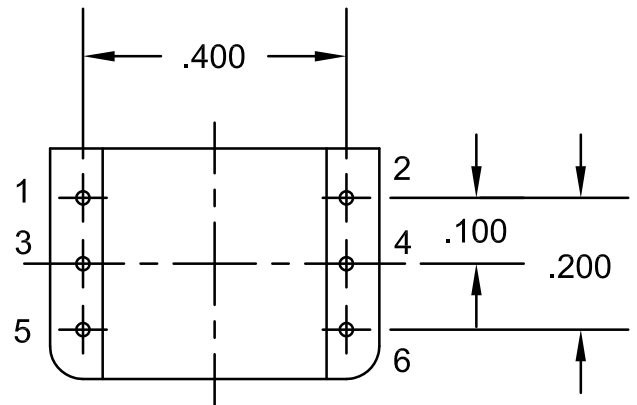

CUSTOM DESIGNS & MODIFICATIONS:

Other electrical configurations and performance characteristics are available in various sizes and package types

M21038/27 SERIES





CONFIGURATION - C

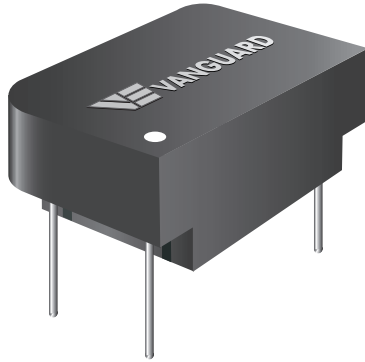

TOP VIEW

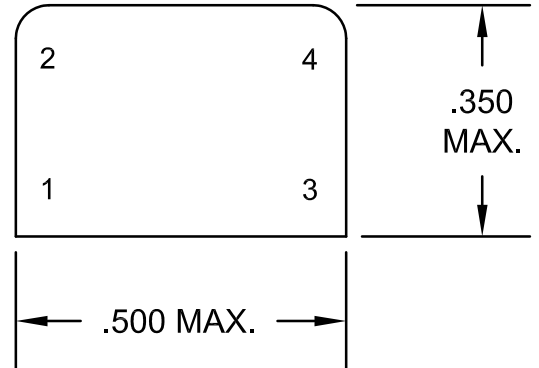

SIDE VIEW

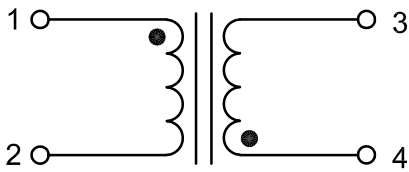
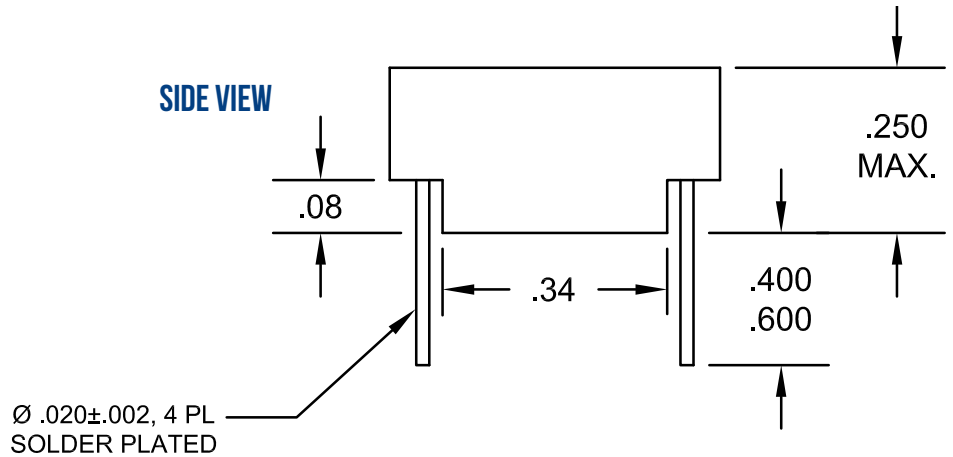

SCHEMATIC

BOTTOM VIEW

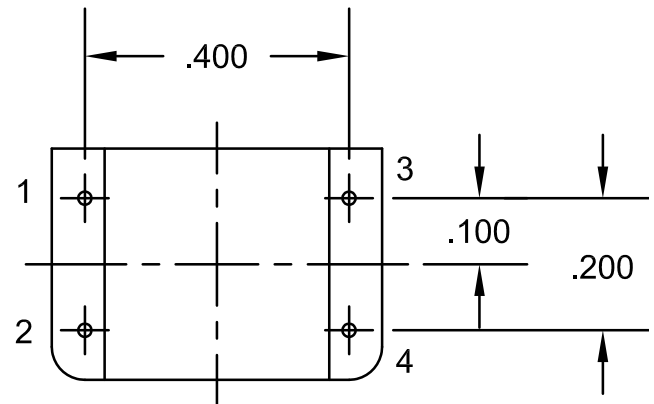

CUSTOM DESIGNS & MODIFICATIONS:

Other electrical configurations and performance characteristics are available in various sizes and package types

M21038/27 SERIES





CONFIGURATION - D

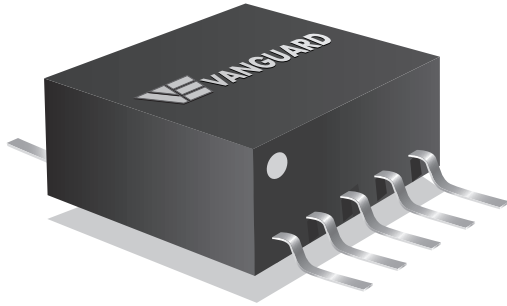

TOP VIEW

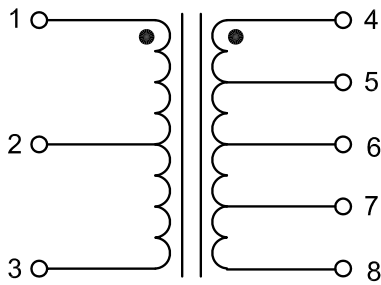

SCHEMATIC FOR -11, -12, -13, -15, & -27

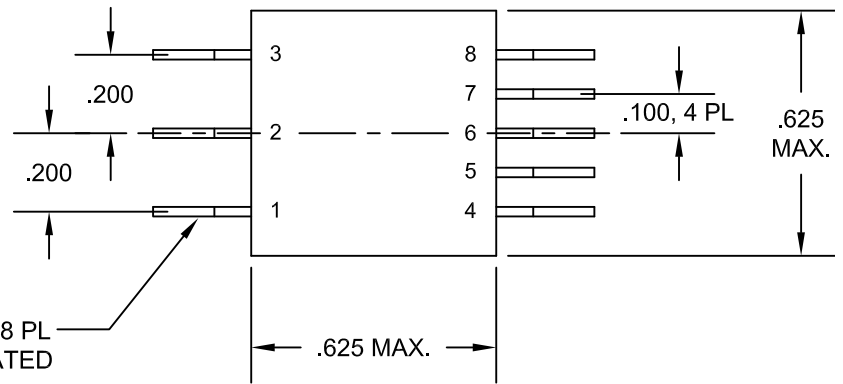

Ø .020±.002, 8 PL SOLDER PLATED

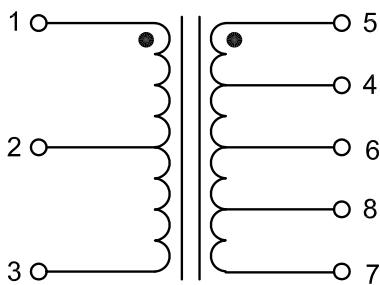

SCHEMATIC FOR -14

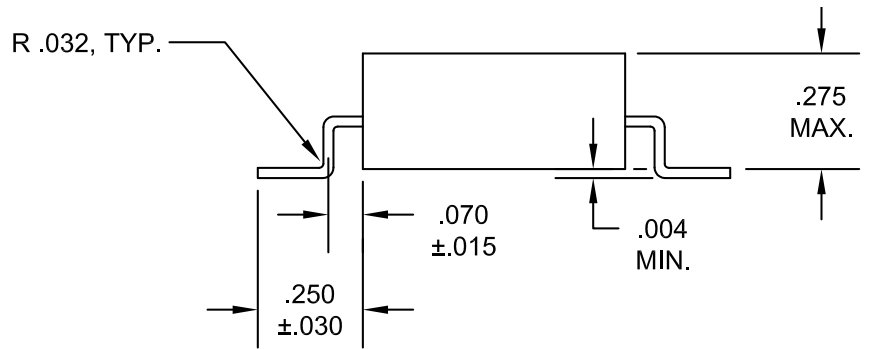

SIDE VIEW

CUSTOM DESIGNS & MODIFICATIONS:

Other electrical configurations and performance characteristics are available in various sizes and package types

M21038/27 SERIES





CONFIGURATION - E

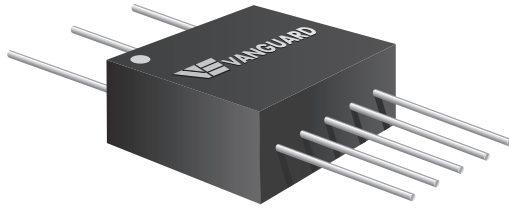

TOP VIEW

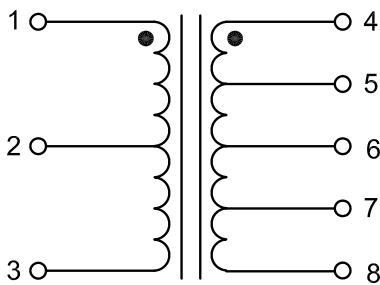

SCHEMATIC FOR -16, -17, -18, -20 & -31

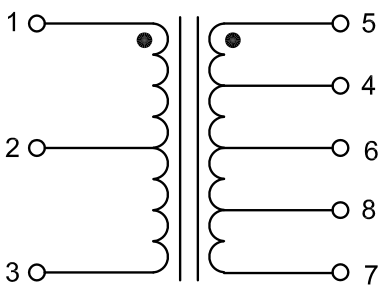
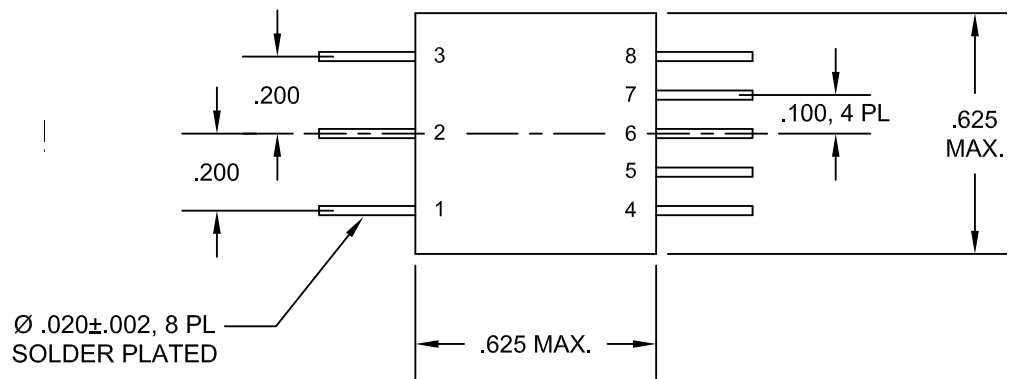

SCHEMATIC FOR -19

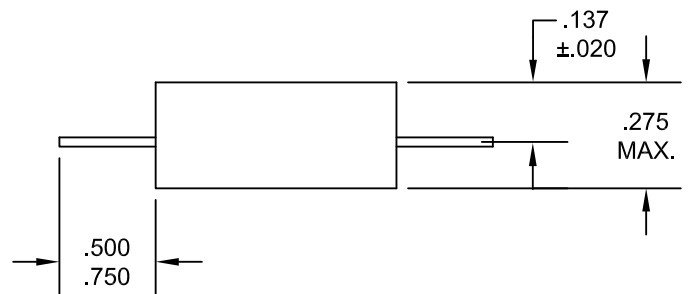

SIDE VIEW

CUSTOM DESIGNS & MODIFICATIONS:

Other electrical configurations and performance characteristics are available in various sizes and package types

M21038/27 SERIES





CONFIGURATION - F

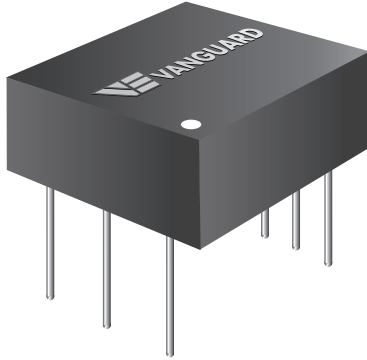

TOP VIEW

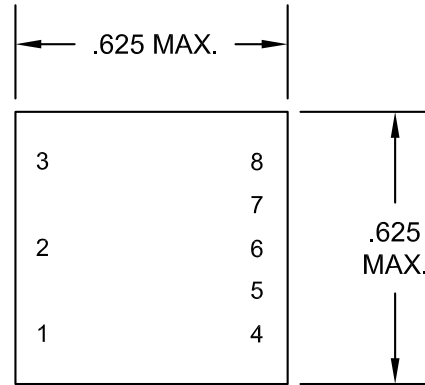

SIDE VIEW

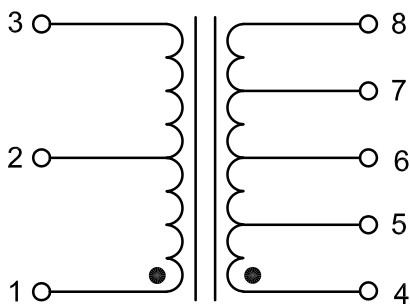
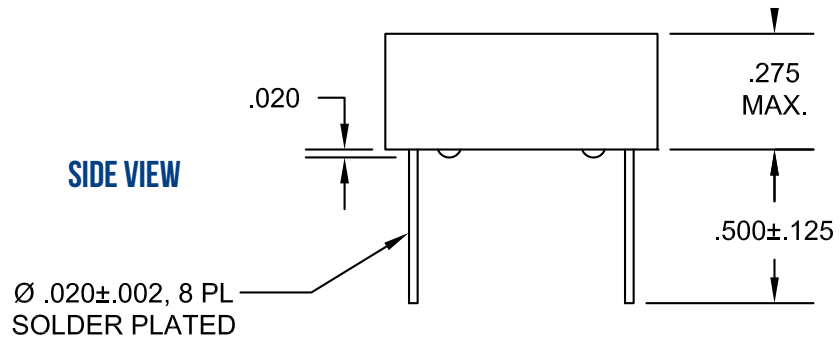

SCHEMATIC

BOTTOM VIEW

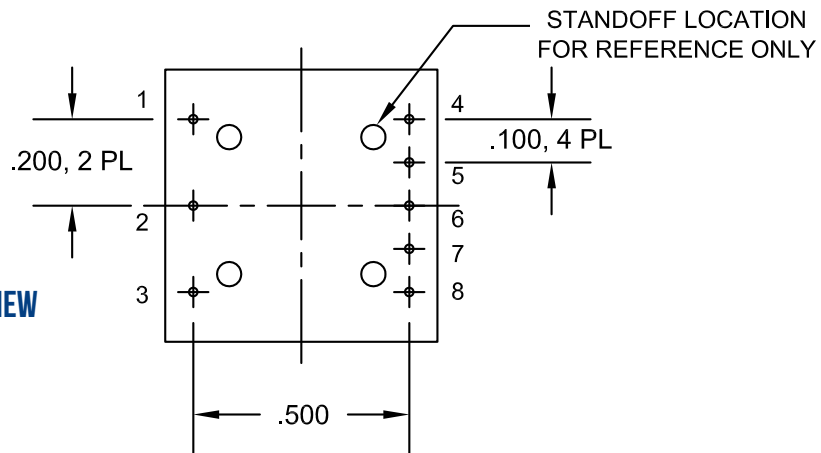

CUSTOM DESIGNS & MODIFICATIONS:

Other electrical configurations and performance characteristics are available in various sizes and package types

M21038/27 SERIES





CIRCUIT '1'

COMMON MODE REJECTION, (CMR)

M21038/27 CIRCUITS

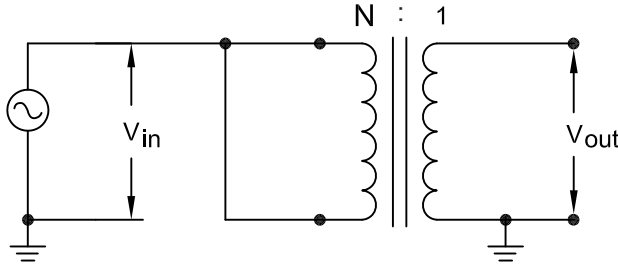

f = 1 MHZ

V_{in} = 10 Vrms

$$CMR = 20 \log_{10} \frac{V_{in}}{V_{out}} = 45 \text{ dB MIN.}$$

CIRCUIT '2'

DROOP, OVERTHOOT AND RINGING

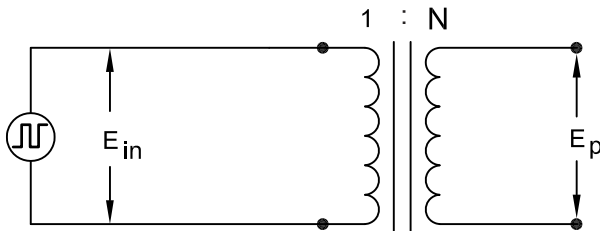

f = 250 KHZ SQUARE WAVE

E_{in} = 27 V pk - pk

N = WINDING OF HIGHEST TURNS

OVERTHOOT AND RINGING ± 1 V MAX. pk

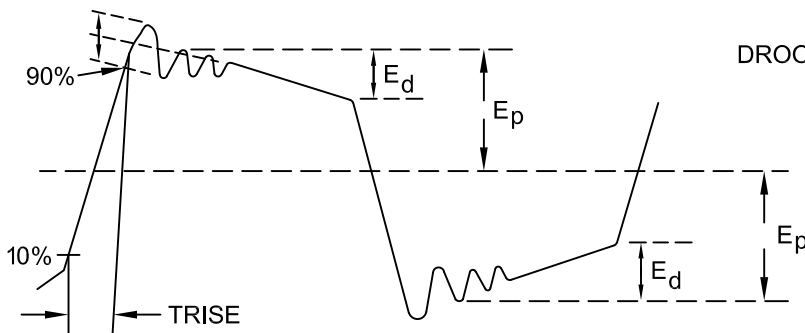

$$DROOP = \frac{E_d}{E_p} \times 100\% = 20\% \text{ MAX.}$$

CUSTOM DESIGNS & MODIFICATIONS:

Other electrical configurations and performance characteristics are available in various sizes and package types

M21038/27 SERIES

